

THE CITY OF NAPOLEON

BUILDING & ZONING DEPARTMENT

255 W. RIVERVIEW

(419)592-4010

Building Permit

Permit Number: BP2006-45

Page 1 of 1

Printed: 4/24/2006

Property Address: 755 Clinton St. W.

Applicant

Approval Date: 4/24/2006

Address: Steve Gerken
755 W. Clinton
Napoleon, OH 43545

Phone: 419-592-0425

Owners

Name: Mr. Steve Gerken
755 W. Clinton
Napoleon, OH 43545

Phone: 419-592-0425

Contractors

Fees and Receipts:

Number	Description	Amount
FEE2006-303	Building Permit Fee (Auto)	\$10.00
Total Fees:		\$10.00
RCPT2006-138		\$10.00

Description

Structure Use:

Start Date:

Construction Value: \$900.00

End Date:

Floor Areas: Living Space:

Basement/Storage:

Garage:

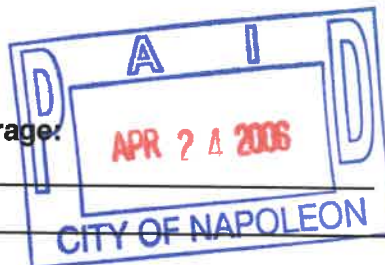

Description of work to be done:

Fence

Applicant signature: Steve Gerken

Date: 4/24/06

CITY OF NAPOLEON GENERAL PERMIT APPLICATION

THIS APPLICATION IS FOR RESIDENTIAL CONSTRUCTION INCLUDING BUILDING, ELECTRICAL, PLUMBING
MECHANICAL, DEMOLITIONS, REMODELING.

DATE: 4/24/06 JOB LOCATION: 755 W. Clinton St.

OWNER: Steve Gerken PHONE: 419-592-0425

OWNER ADDRESS: 755 W. Clinton St. CITY: _____ ZIP: _____

CONTRACTOR: Self

PHONE #: _____ CELL PHONE# _____

CONTRACTOR LICENSED WITH THE CITY OF NAPOLEON?: YES NO:

Is any of the above job going to be subcontracted out? Yes No:

If yes to whom: _____

DESCRIPTION OF WORK TO BE PERFORMED: _____

ESTIMATED COMPLETION DATE: _____

PLEASE MARK THE TYPE OF WORK YOU WILL BE PERFORMING

- | | |
|---|--|
| <input type="checkbox"/> A/C ADD ON | <input type="checkbox"/> REMODELING |
| <input type="checkbox"/> BOILER REPLACEMENT | <input type="checkbox"/> ROOFING |
| <input type="checkbox"/> CURBING | <input type="checkbox"/> SEWER REPAIRS** |
| <input type="checkbox"/> DECKS * | <input type="checkbox"/> SIDEWALK* |
| <input type="checkbox"/> DRIVEWAY* | <input type="checkbox"/> SIDING |
| <input type="checkbox"/> ELECTRICAL SERVICE UPGRADE | <input type="checkbox"/> STORAGE SHED* |
| <input type="checkbox"/> ELECTRICAL SERVICE NEW | <input type="checkbox"/> SWIMMING POOL* |
| <input checked="" type="checkbox"/> FENCE* | <input type="checkbox"/> FURNACE REPLACEMENT |
| <input type="checkbox"/> ADDITIONS* | <input type="checkbox"/> TEMP ELECTRIC |
| <input type="checkbox"/> FURNACE NEW | <input type="checkbox"/> WATER TAP (size _____") |
| <input type="checkbox"/> LAWN METER | <input type="checkbox"/> WINDOWS |
| <input type="checkbox"/> PLUMBING | <input type="checkbox"/> ZONING |

*PLEASE INCLUDE A PICTURE SHOWING MEASUREMENTS FROM EXISTING STRUCTURES AND PROPERTY LINES. INDICATING THE TYPE OF WORK YOU WISH TO PERFORM.

** IF WORK REQUIRES GOING INTO THE STREET A STREET BOND IS REQUIRED!

FOR PERMIT COSTS PLEASE FILL OUT REVERSE SIDE

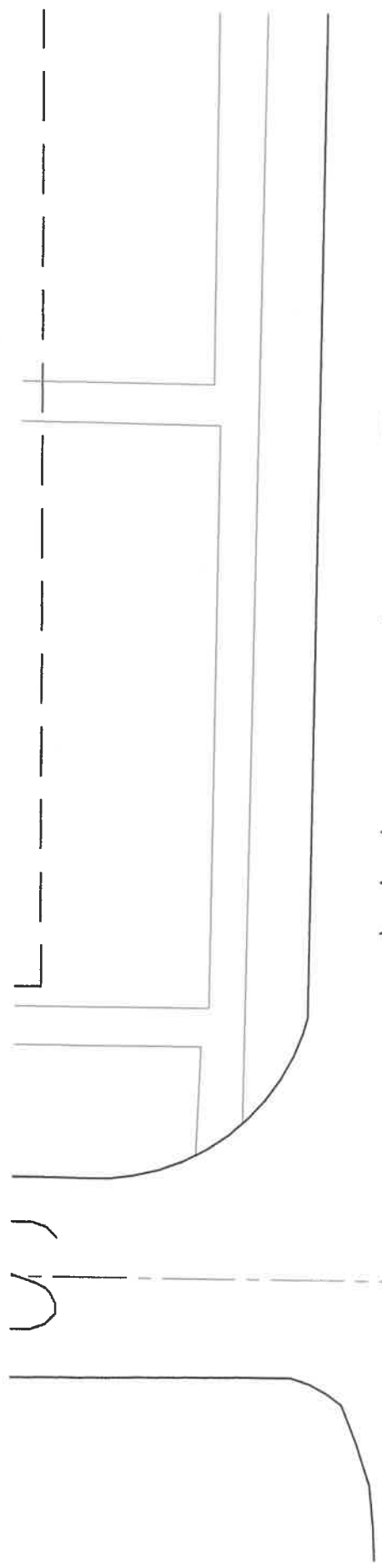

West Clinton

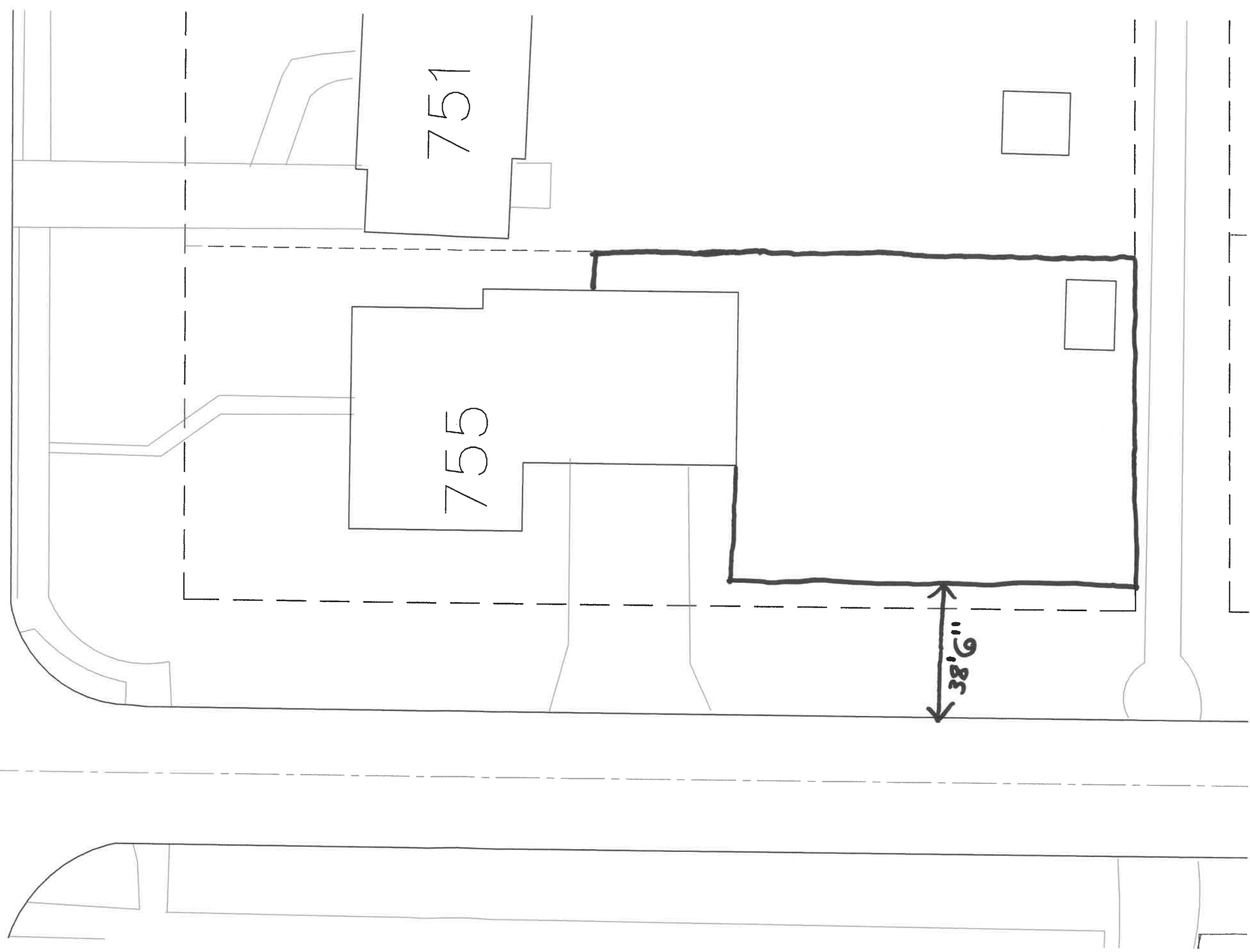

751

755

38'6"

N